

WELD ON FITTINGS

90° L.R. Elbows

ASTM A 403 WPW 304/304L & 316/316L
 ASME SA 403 WPW
 SCH 10 & SCH 40 Wall thickness

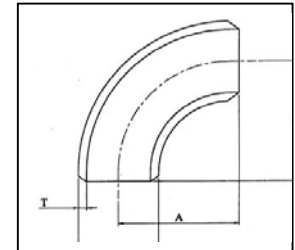

Nominal Pipe Size		Outside Diameter (OD)	SCH 10 Wall Thickness (T)	Centre to End (A)	SCH 10 Weight (KG)	SCH 40 Wall Thickness (T)	SCH 40 Weight (KG)
(mm)	(inches)						
15	1/2	21.34	2.11	38.40	0.0060	2.77	0.076
20	3/4	26.67	2.11	28.50	0.057	2.87	0.076
25	1	33.40	2.77	38.10	0.156	3.38	0.150
32	1 1/4	42.16	2.77	47.62	0.201	3.56	0.253
40	1 1/2	48.26	2.77	57.15	0.279	3.68	0.363
50	2	60.32	2.77	76.20	0.470	3.91	0.651
65	2 1/2	73.02	3.05	95.25	0.786	5.16	1.29
80	3"	88.90	3.05	114.30	1.16	5.49	2.02
100	4"	114.30	3.05	152.40	2.00	6.02	3.84
125	5"	141.30	3.40	190.50	3.46	6.55	6.51
150	6"	168.27	3.40	228.60	4.96	7.11	10.1
200	8"	219.07	3.76	304.80	9.55	8.18	20.3
250	10"	273.05	4.19	381.00	16.6	9.27	36.0
300	12"	323.85	4.57	457.20	25.8	9.52	53.0
350	14"	355.60	4.78	533.40	34.6	9.52	68.0
400	16"	406.40	4.78	609.60	45.2	9.52	89.2
450	18"	457.20	4.78	685.80	57.3	9.52	113
500	20"	508.00	5.54	762.00	82.0	9.52	140
550	22"	558.80	5.54	838.20	99.4	9.52	170
600	24"	609.60	6.35	914.40	136	9.52	202