

## BSP FITTINGS

### Equal Tees BSP

Screwed female parallel thread  
ASA 150 lb (68kg) rating

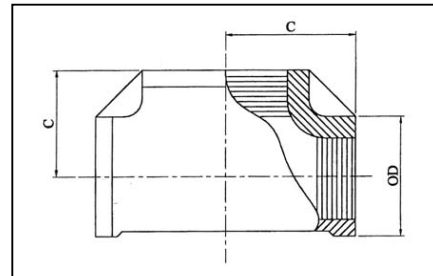

Available in grade **316/316L**

Nominal Bore		Centre to End (C)	Outside Diameter (OD)
(mm)	(inches)	(mm)	(mm)
6	$\frac{1}{8}$	18	14
8	$\frac{1}{4}$	19	17
10	$\frac{3}{8}$	23	21
15	$\frac{1}{2}$	27	26
20	$\frac{3}{4}$	31	32
25	1	37	40
32	$1 \frac{1}{4}$	44	49
40	$1 \frac{1}{2}$	47	55
50	2	56	68
65	$2 \frac{1}{2}$	68	85
80	3	77	99
100	4	99	125